

X

The Bungalow

52'
1387 Sq Ft
3 Bedrooms

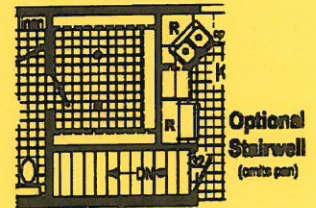
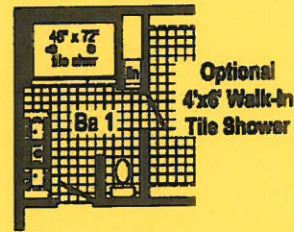
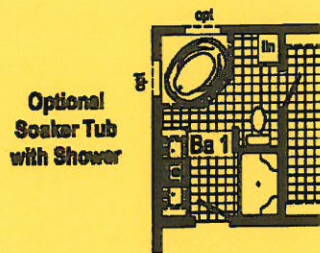
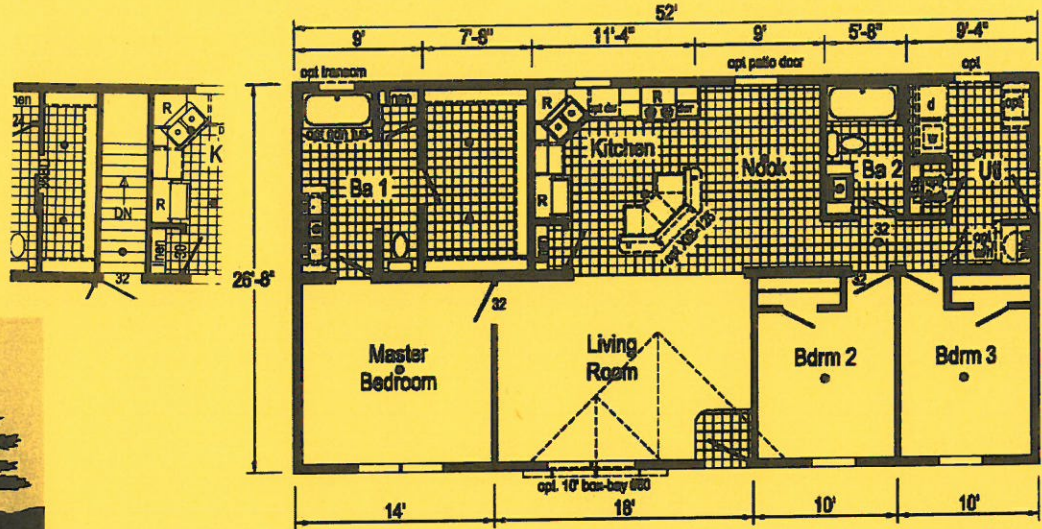
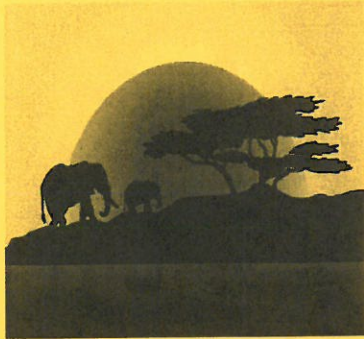

Standard Features

- 6" Walls & Northern Insulation
- 8' Sidewalls & Flat Ceilings
- O.S.B. Sheathing & Wind Wrap
- Owens Corning Shingled Roof w/Ice Guard
- Maintenance Free Vinyl Siding
- 6 Panel Steel Doors w/Dead Bolt Locks
- Thermopane Low-E Vinyl Windows
- 100 Amp Service (200 Amp in Modulares)
- Orange Peel Finished Drywall Throughout

- 18 C.F Frost Free Refrigerator
- 30" Gas Range
- 60" Fiberglass Tubs
- China Bath Sinks
- Huntington Brass Faucets
- Shaker Oak Cabinets & Oak Face Frames
- Congoleum Heavy Gauge Floor Vinyl
- Exterior Faucet & Outlets
- White 2 Panel Interior Doors & Trim

Recommended Features

- 22" Eave Overhangs (Modular only)
- Transom Window in Hall Bath
- Window in Master Bath & Utility Room
- Lighted Paddle Fan
- (3) Additional LED Lights in Kitchen
- Dishwasher
- Utility Sink
- Window in Rear Door
- Dormer

Additional Features Shown

- Patio Door
- Cathedral Ceiling
- Microwave
- Full Wall Ceramic Backsplash
- Upgrade Island in Kitchen
- 54" Ceramic Shower
- Sliding Ship Lap Bath Door
- Barnwood Moldings IPO White
- (2) Solid Core Doors

SHOWN AS
U.D.C. MODULAR

Town and Country Housing
4285 S. Prairie View Rd, Chippewa Falls WI 54729 715-834-1279
Visit us on the web at www.townandcountryhousing.com

Specifications subject to change without notice
Paint by Others

