

# Y The Mariner

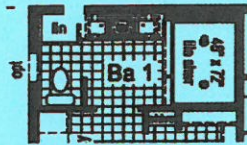

1493 Sq Ft  
3 Bed/2 Bath



Optional  
4'x6' Walk-In  
Tile Shower

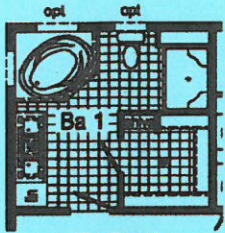

Optional  
Soaker Tub with  
Shower  
(omits vanity)

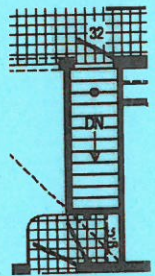
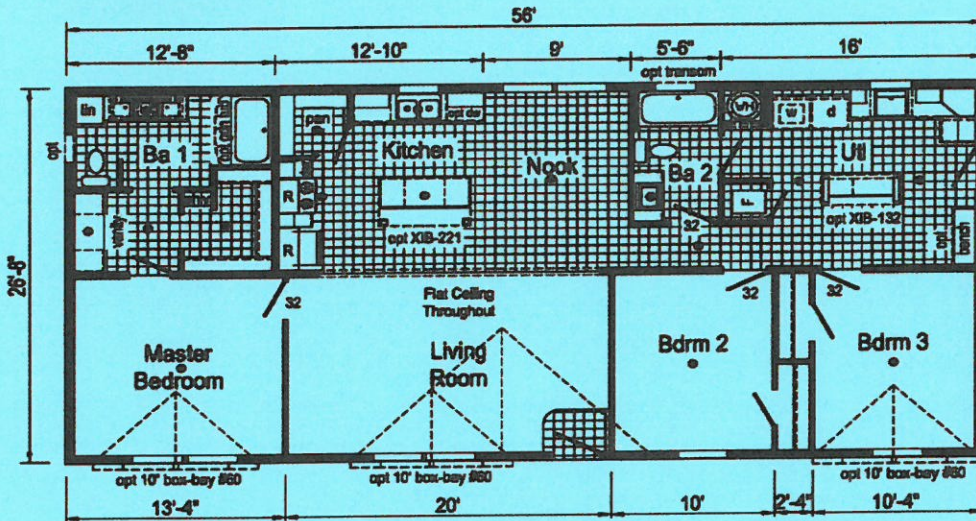

## Standard Features

- 6" Walls & Northern Insulation
- 8' Sidewalls & Flat Ceilings
- O.S.B. Sheathing & Wind Wrap
- Owens Corning Shingled Roof w/Ice Guard
- Maintenance Free Vinyl Siding
- 6 Panel Steel Doors w/Dead Bolt Locks
- Thermopane Low-E Vinyl Windows
- 100 Amp Service (200 Amp in Modulares)
- Orange Peel Finished Drywall Throughout

- 18 C.F Frost Free Refrigerator
- 30" Gas Range
- 60" Fiberglass Tubs
- China Bath Sinks
- Huntington Brass Faucets
- Shaker Oak Cabinets & Oak Face Frames
- Congoleum Heavy Gauge Floor Vinyl
- Exterior Faucet & Outlets
- White 2 Panel Interior Doors & Trim



## Recommended Features

- Patio Door
- Transom Window in Hall Bath
- Window in Master Bath
- Lighted Paddle Fan
- Kitchen LED & Stem Lights
- Utility Sink
- Architectural Shingles
- 22" Overhangs (Modular Only)
- Twin Peak Double Dormer
- Optional Storage Closet in Utility Room

## Additional Features

- Box Bay Window
- Shaker Accent Dormer
- Leaded Glass Front Door
- Stainless Steel Appliance Package
- Stainless Steel Microwave
- Upgrade Island in Kitchen & Utility Room
- Corner Soaker Tub Bath
- Sliding 2 Panel Master Bath Door
- Ship Lap Accent Wall
- Double Sinks in Master Bath

Town and Country Housing  
4285 S. Prairie View Rd, Chippewa Falls WI 54729 715-834-1279  
Visit us on the web [www.townandcountryhousing.com](http://www.townandcountryhousing.com)  
Specifications subject to change without notice  
Paint by others