

D

The Autumn Lodge

48'
1220 Sq Ft
2 Bed
2 Bath

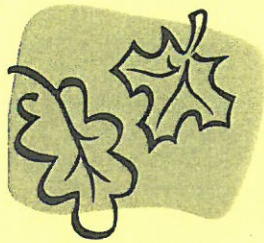
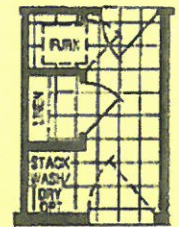
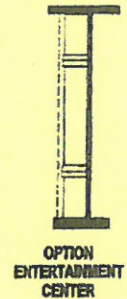
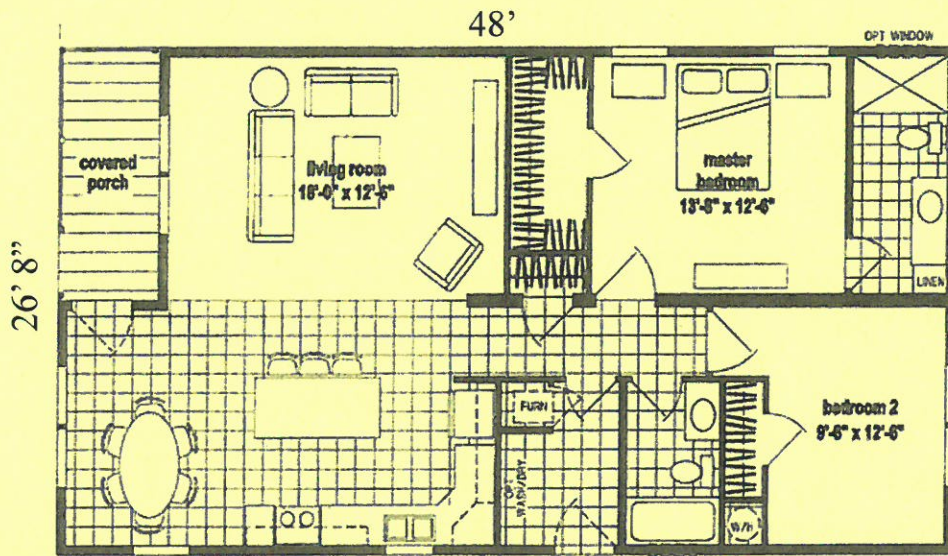

Standard Features

- 6" Walls & Northern Insulation
- 90" Sidewalls & Cathedral Ceilings
- 30 Year Architectural Shingles
- Thermopane "Low E" Windows
- Maintenance Free Vinyl Siding
- OSB Sheathing & Wind Wrap
- Sunburst Front Door
- 9-Lite Rear Door
- Dead Bolt Locks
- Ceramic Tile Back Splashes
- Smoke & Co2 Detectors

- 100 Amp Service (200 in modular)
- Whole House Water Shut Off
- 18 Cu. Ft. Frost Free Refrigerator
- 30" Gas or Electric Range
- 1 Piece Fiberglass Tub (Hall Bath)
- 48" Fiberglass Shower (Master Bath)
- Single Lever Faucets
- China Bath Sinks
- Oak Cabinet Doors & Face Frames
- Premium Floor Vinyl
- Exterior Faucet & Outlets

Recommended Features

- Finished Drywall
- Lighted Paddle Fan
- Cabinet Over Washer/Dryer
- Lazy Susans
- Dishwasher
- Cabinet Over Stool
- 51" Medicine Cabinet in Main Bath
- Medicine Cabinet in Hall Bath
- 200 AMP Service

Additional Features Shown

- Entertainment Center
- Slide Out Base Shelves
- Microwave
- Clay Trim, Doors & Windows
- Box Bay Window with Eyebrow
- 72" Transom Window in Living Room
- Transom Window in Each Bath
- Premium Vinyl Siding
- Pocket Door to Master Closet

Town and Country Housing

4285 S Prairie View Rd, Chippewa Falls WI 54729

715-834-1279

Visit us on the web at www.townandcountryhousing.com

Specifications subject to change without notice ~ Paint By Others